

INLET BEARING HOUSING DETAIL

NOTES:--DIMENSIONS IN PARENTHESIS ARE IN INCHES.
 --RECOMMENDED TIE ROD TORQUE : 30 F.T. LBS.
 --USED GREASE SPECIFICATIONS : HP-ST3
 EQUIVALENT: ESSO: BEACON 3
 ELF: ROLEXA 3
 TOTAL: MULTIS TIR
 SHELL: ALVANIA EP3
 MOBIL: MOBILUX EP3

REV	DATE	E.D.N	BY	REVISIONS
8	06/07/02	89310001	BO	ORIGINAL

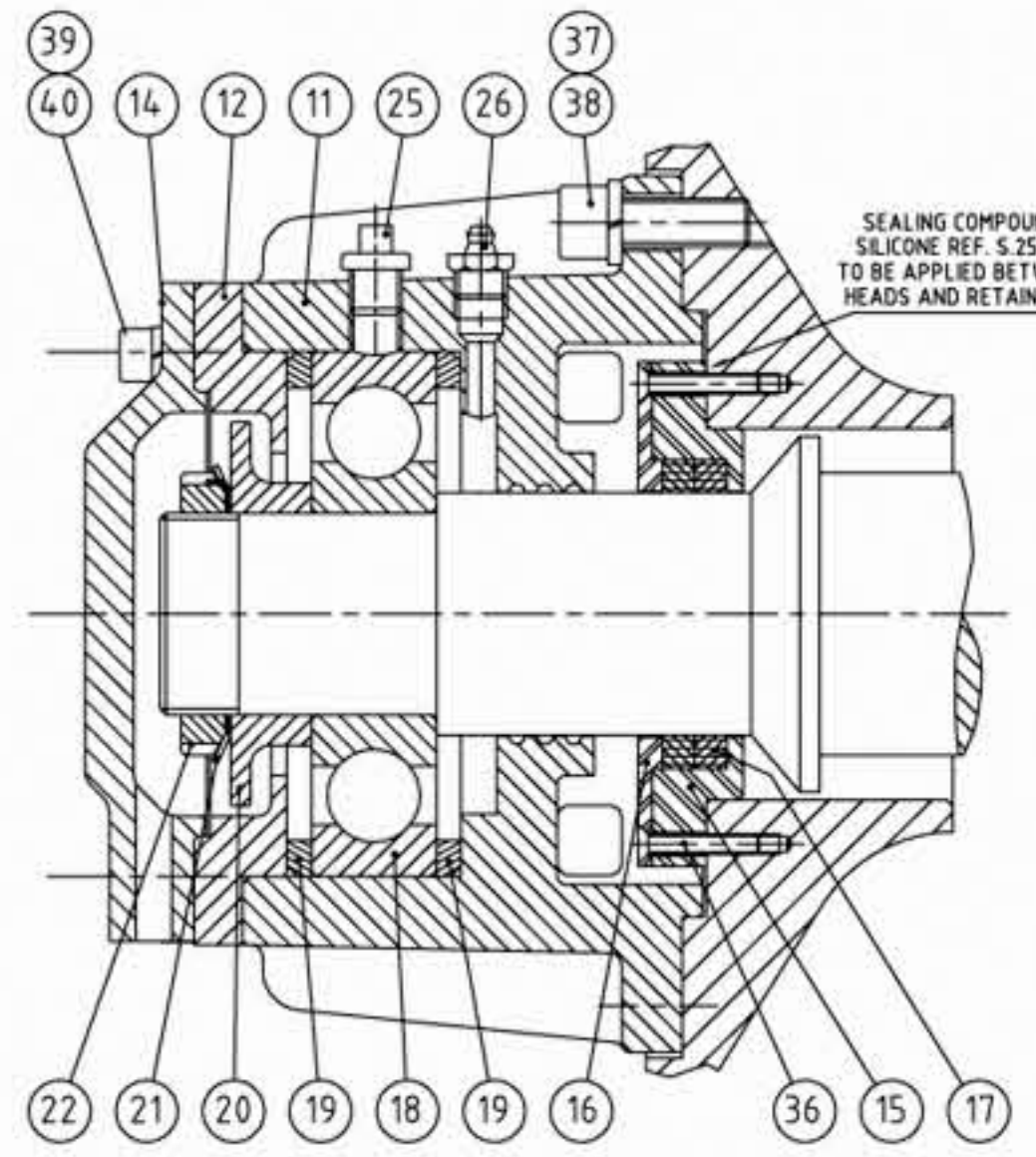

SEALING COMPOUND SILICONE REF. S.2523 TO BE APPLIED BETWEEN HEADS AND RETAINERS

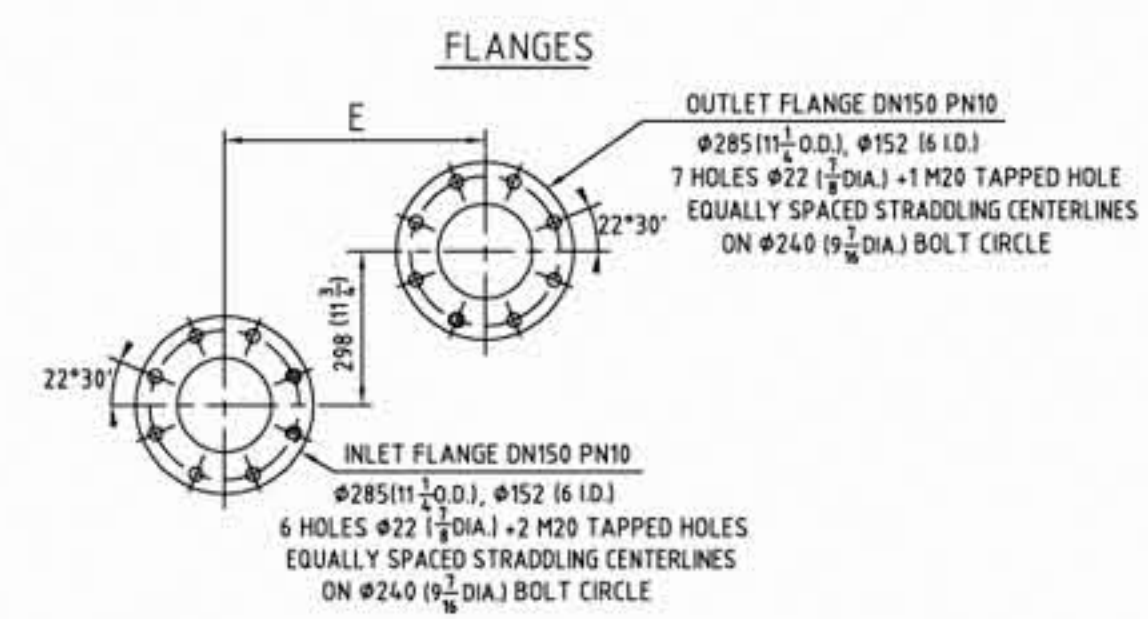

FOOT DIMENSIONS, ALL HEADS

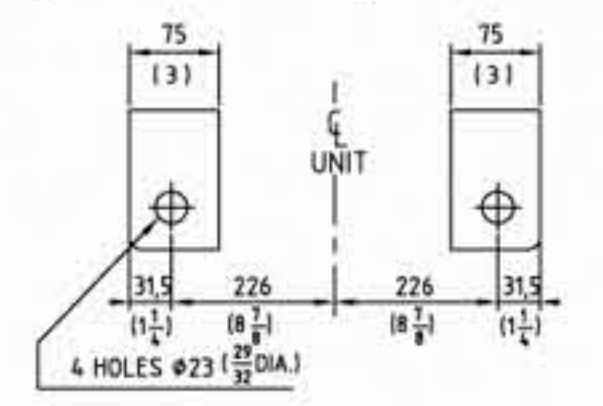

DETAIL A



DETAIL B

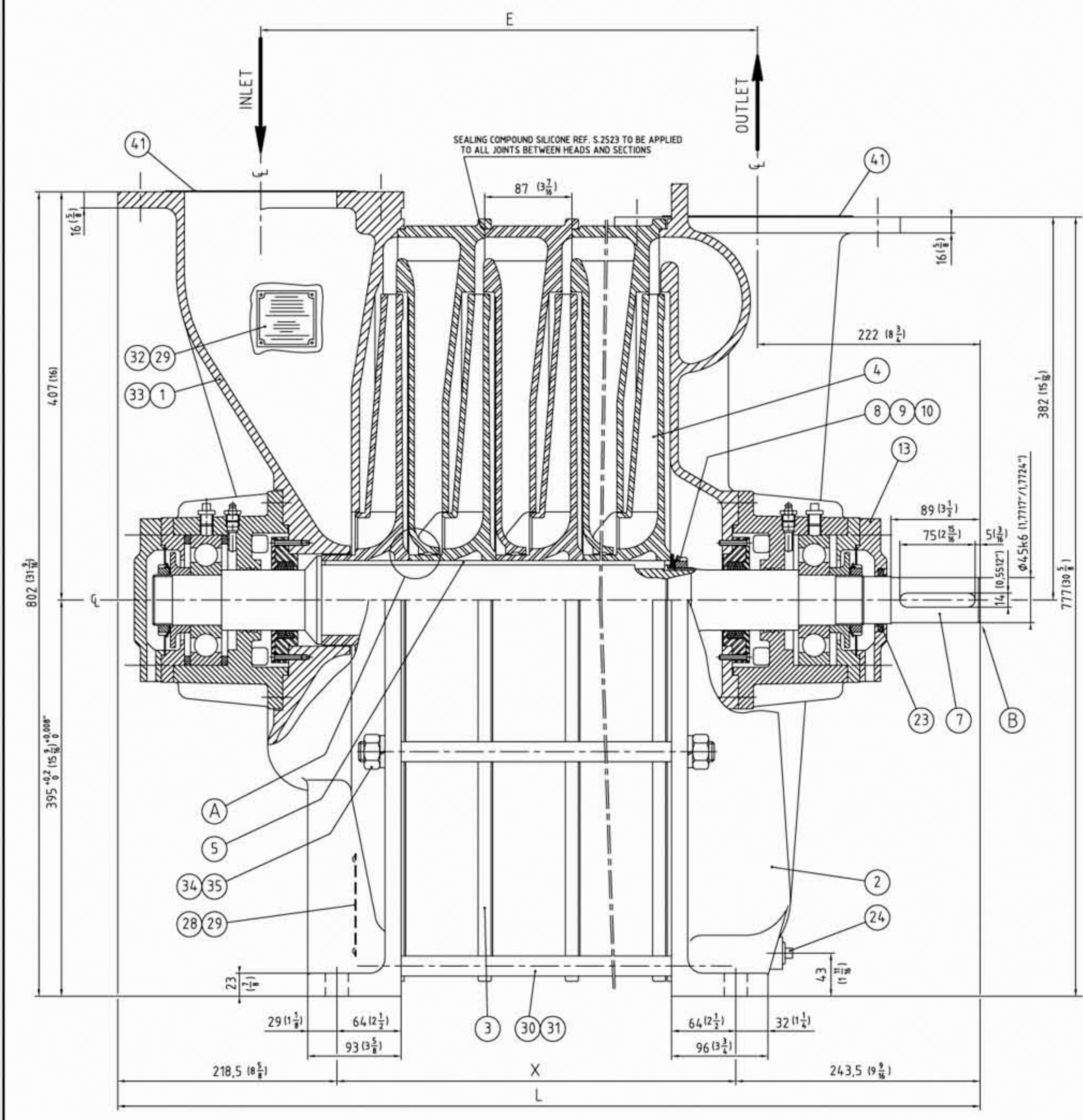
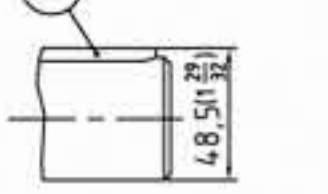

Chart II		IMPELLER TYPE (ITEM 4)	
QTY.	PART NO.	IMPELLER TYPE	DWG.
	S.0641	N°3202	30-05
	S.4604	N°3203	31-02
	S.0642	N°3211	30-04

Chart I	TYPE	031A.01	031A.02	031A.03	031A.04	031A.05	031A.06	031A.07	031A.08	031A.09
PART NO. ITEM 5	S.0646	S.0647	S.0648	S.0649	S.0650	S.0651	S.0652	S.4610	S.4620	
PART NO. ITEM 7	S.0627	S.0629	S.0631	S.0633	S.0635	S.0637	S.0639	S.4608	S.4621	
WEIGHT: kg, ITEM 7	11.5	14.2	16.8	19.5	22.1	24.7	27.3	29.9	32.5	
PART NO. ITEM 30	S.1241	S.0645	S.1243	S.0695	S.1035	S.1249	S.0697	S.1451	S.4623	
PART NO. ITEM 31	S.1241S	S.0645S	S.1243S	S.0695S	S.1035S	S.1249S	S.0697S	S.1451S	S.4623S	
QTY:	ITEM 3	0	1	2	3	4	5	6	7	8
	ITEM 4	1	2	3	4	5	6	7	8	9
DIMENSION E		234,5 (9 1/4)	321,5 (12 5/8)	408,5 (16 1/8)	495,5 (19 5/8)	582,5 (22 9/16)	669,5 (26 3/8)	756,5 (29 3/8)	843,5 (33 1/8)	930,5 (36 5/8)
DIMENSION X		137 (5 3/8)	224 (8 7/8)	311 (12 1/4)	398 (15 5/8)	485 (19 1/2)	572 (22 5/8)	659 (25 9/16)	746 (29 3/8)	833 (32 7/8)
DIMENSION L		599 (23 5/8)	686 (27)	773 (30 3/4)	860 (33 7/8)	947 (37 3/8)	1034 (40 7/8)	1121 (44 1/8)	1208 (47 5/8)	1295 (51)
WEIGHT: kg		233	273	313	353	393	433	473	513	553
WEIGHT: LBS		514	602	690	778	866	954	1042	1131	1219

41	2	S.0624	COVER, PORT		C.STEEL
40	12	CHC M8-040	SCREW, CHC M8-40		
39	12	W8	WASHER LOCK, W8		
38	12	CHC M12-035	SCREW, CHC M12-35		
37	12	W12	WASHER LOCK, W12		
36	12	FHC M05-030	SCREW, FHC M5-30		
35	14	H M20	NUT, H20		
34	14	W20	WASHER LOCK, W20	008	
33	1	S.1802	VALVE WARNING PLATE	092	
32	1	S.1801	SURGE WARNING PLATE	010	ALUMINIUM
31	2	See chart I	TIE ROD (short)	010	C.STEEL
30	6	See chart I	TIE ROD (long)	010	C.STEEL
29	8	CT02.89-008	RIVET, Ø2,89-8		
28	1	S.0216	NAME PLATE	284	ALUMINIUM
27	1	S.0613	KEY, COUPLING 14x9x75	003	C.STEEL
26	2	S.0621	GREASER, 1/4 GAS		
25	2	S.0200	PLUG, 1/4 GAS		
24	1	S.1012	PLUG, 3/8 GAS		
23	1	S.0623	FELT JOINT Ø63x46x6		
22	2	S.0620	NUT, KM10		
21	2	S.0619	WASHER, MB10		
20	2	S.0610	GREASE SLINGER	30-20	C.STEEL
19	2	S.0611	SPACER, BEARING / HOUSING BEARING	30-18	C.STEEL
18	2	S.0617	BEARING, BALL 6410 C3		1,95
17	4	S.0862	GRAPHIT RING		GRAPHIT
16	2	S.0856	ADAPTER, GRAPHIT RING	50-36	ALUMINIUM 0,1
15	2	S.0855	RETAINER, GRAPHIT RING	50-36	ALUMINIUM 0,36
14	1	S.4663	CAP, BEARING-OUTLET END	31-46	CAST IRON 1,9
13	1	S.4664	CAP, BEARING-INLET END	31-46	CAST IRON 1,67
12	2	S.4665	SPACER, BEARING/CAP	31-47	CAST IRON 1,7
11	2	S.4661	HOUSING, BEARING	31-45	CAST IRON 10
10	1	S.1222	NUT, KM13		
9	1	S.1221	WASHER, MB13		
8	2	S.4611	WAVY SPRING		C.STEEL
7	1	See chart I	SHAFT	30-06	C.STEEL See chart I
6	Variable	S.0668	SHIM, IMPELLER	006	C.STEEL
5	1	See chart I	KEY, IMPELLER	003	C.STEEL
4	See chart I	See chart II	IMPELLER	See chart I	ALUMINIUM 9
3	See chart I	S.4603	SECTION, INTERMEDIATE	31-01	ALUMINIUM 25
2	1	S.0602	HEAD, OUTLET	30-02	CAST IRON 80
1	1	S.0601	HEAD, INLET	30-01	CAST IRON 85

ITEM	QTY.	PART NO.	DESCRIPTION	DWG.	MATERIAL	WEIGHT kg
CONTINENTAL INDUSTRIE S.A. TYPE 031A OUTLET END DRIVE						
TRIVIER/MOIGNANS FRANCE SECTIONAL DRAWING GRAPHIT RING SEAL						
ASSEMBLY: DATE: 01/12/2003						
SCALE: SIZE: A1						
QUOTATION: DR: BO CHKD. DR DWG No. REV.						
REVISIONS: 31A-RG1A 0						

Ce plan est notre propriété et ne peut être copié ou communiqué à des tiers sans notre autorisation