

**INLET BEARING HOUSING DETAIL**

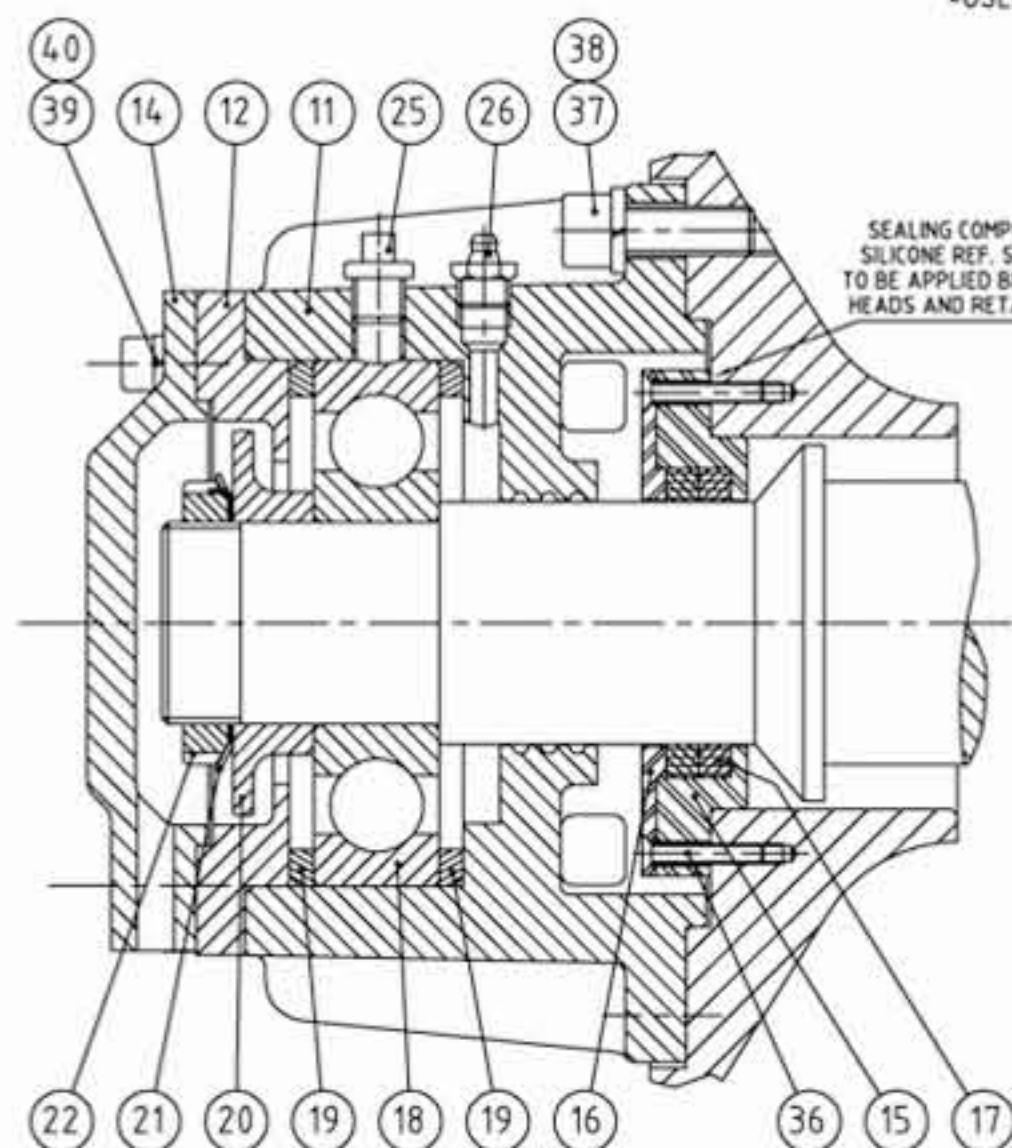

NOTES: -DIMENSIONS IN PARENTHESIS ARE IN INCHES.  
 -RECOMMENDED TIE ROD TORQUE : 30 F.T. LBS.  
 -USED GREASE SPECIFICATIONS : HP-ST3  
 EQUIVALENT: ESSO: BEACON 3  
 ELF: ROLEXA 3  
 TOTAL: MULTIS TIR  
 SHELL: ALVANIA EP3  
 MOBIL: MOBILUX EP3

REV	DATE	EDN	BY	REVISIONS
0			BO	ORIGINAL

NOTE: -TYPE 051A.08 : ROTATION SPEED < 3000 RPM.  
 -FOR ROTATION SPEED > 3000 RPM, SEE DRAWING 51A-RG2F et 51A-RG3F.

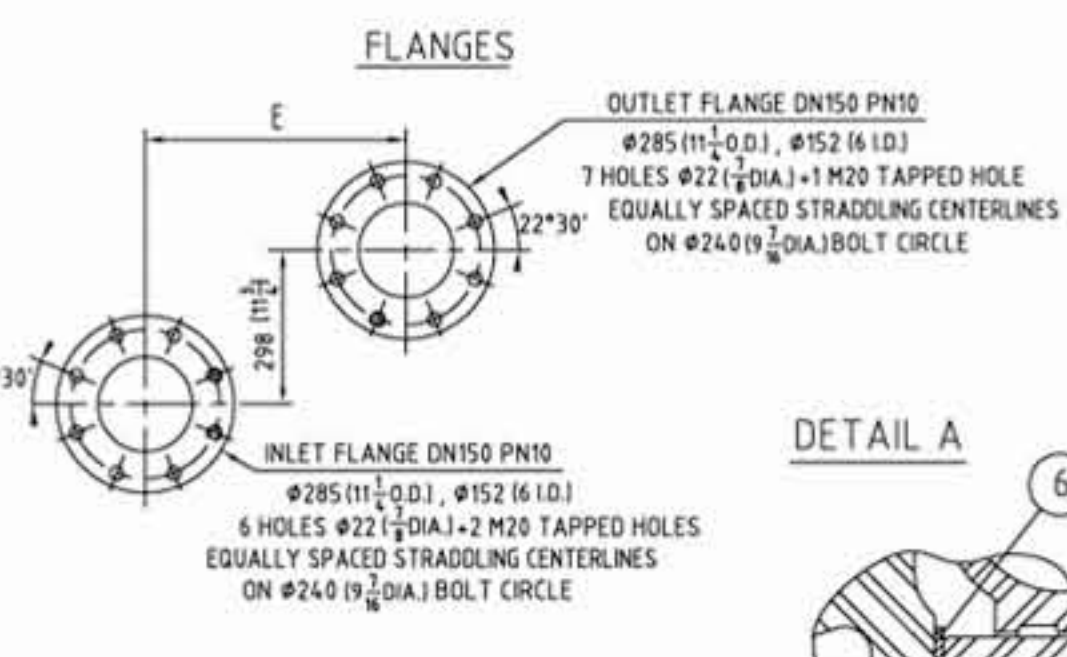
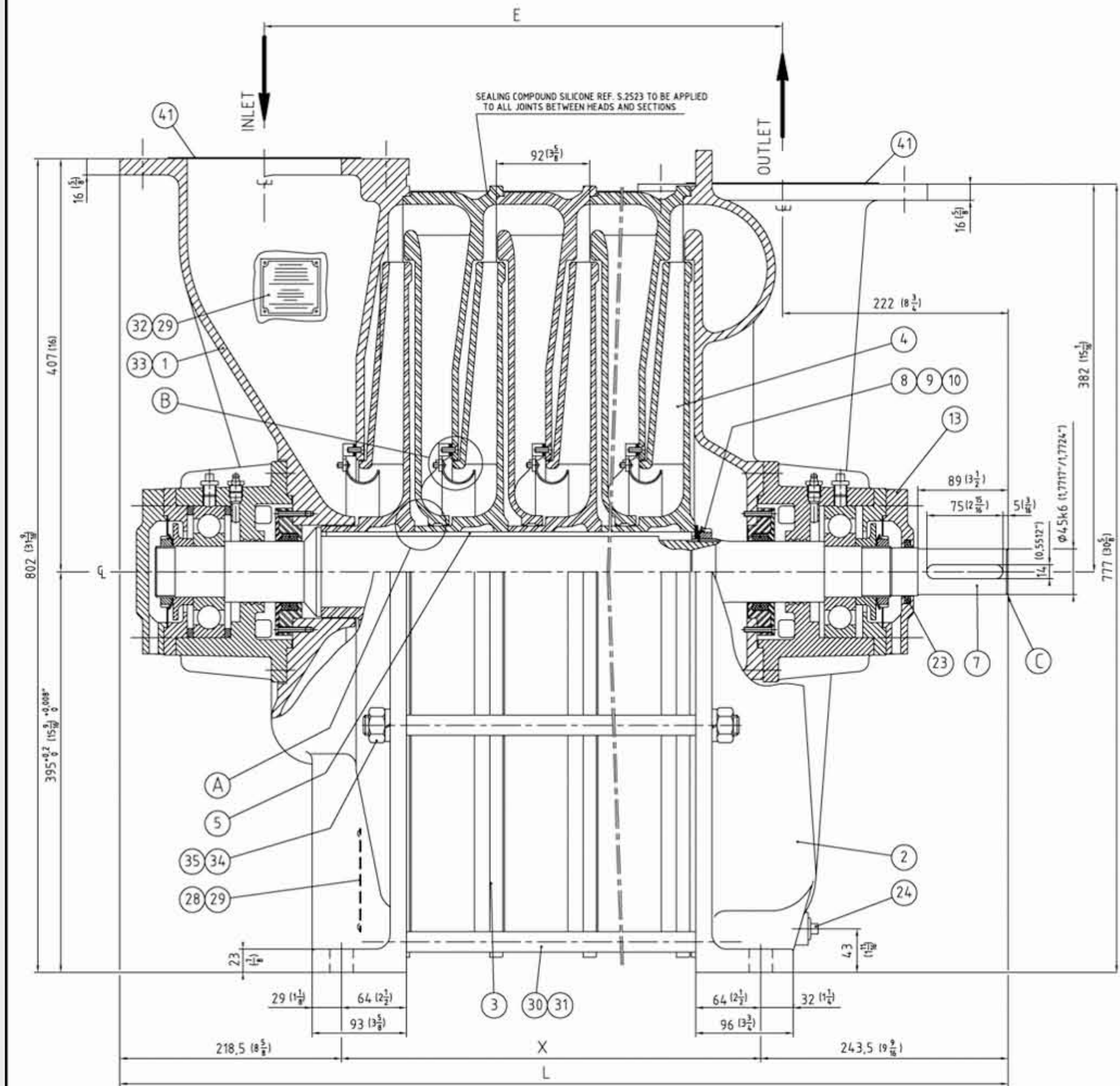

**FOOT DIMENSIONS, ALL HEADS**

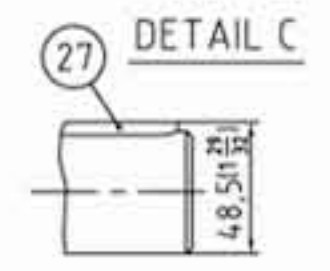
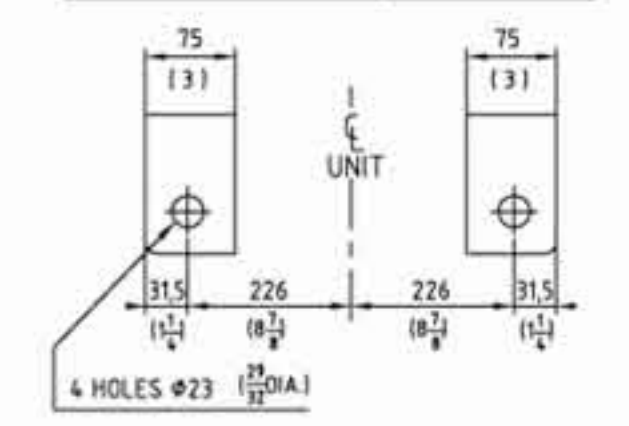

Chart II		IMPELLER TYPE (ITEM 4)	
QTY.	PART NO.	IMPELLER TYPE	DWG.
	S.4999	N°4202	51-89
	S.0819	N°4205	50-05
	S.5022	N°4208	51-117
	S.4904	N°4212	51-02

Chart I	TYPE	051A.01	051A.02	051A.03	051A.04	051A.05	051A.06	051A.07	051A.08
PART NO. ITEM 5	S.0827	S.0828	S.0829	S.0830	S.0831	S.0832	S.0833	S.4910	
PART NO. ITEM 7	S.5023/1	S.5023/2	S.5023/3	S.5023/4	S.5023/5	S.5023/6	S.5023/7	S.5023/8	
WEIGHT:kg, ITEM 7	11.6	14.3	17.1	19.9	22.7	25.4	28.2	31	
PART NO. ITEM 30	S.1241	S.0645	S.1243	S.1247	S.0822	S.1248	S.1037	S.4911	
PART NO. ITEM 31	S.1241S	S.0645S	S.1243S	S.1247S	S.0822S	S.1248S	S.1037S	S.4911S	
QTY.	ITEM 3	ITEM 4	ITEM 4.2	ITEM 4.3	ITEM 4.4	ITEM 4.5			
	0	1	2	3	4	5	6	7	
	1	2	3	4	5	6	7	8	
	1	2	3	4	5	6	7	8	
	4	8	12	16	20	24	28	32	
	4	8	12	16	20	24	28	32	
	4	8	12	16	20	24	28	32	
DIMENSION E	234,5 (9 1/4)	326,5 (12 7/8)	418,5 (16 1/2)	510,5 (20 1/8)	602,5 (23 3/4)	694,5 (27 3/8)	786,5 (31)	878,5 (34 5/8)	
DIMENSION X	137 (5 3/8)	229 (9)	321 (12 5/8)	413 (16 1/4)	505 (19 7/8)	597 (23 5/8)	689 (27 1/4)	781 (30 3/4)	
DIMENSION L	599 (23 5/8)	691 (27 1/8)	783 (30 7/8)	875 (34 3/8)	967 (38 1/8)	1059 (41 5/8)	1151 (45 3/8)	1243 (48 7/8)	
WEIGHT: kg	233	274	316	357	398	439	480	521	
WEIGHT: LBS	514	604	696	787	877	968	1058	1148	

4.6	Variable	MOS.1	WASHER, M5		S.STEEL
4.5	See chart I	GS M05-010	SCREW, GS M5-10		S.STEEL
4.4	See chart I	FHC M05-016	SCREW, FHC M5-16		S.STEEL
4.3	See chart I	S.0823	BRACKET, BAFFLE	50-20	S.STEEL
4.2	See chart I	S.0826	BAFFLE	50-12	S.STEEL
4.1	2	S.0624	COVER, PORT	050	C.STEEL
4.0	12	CHC M8-040	SCREW, CHC M8-40		
3.9	12	W8	WASHER LOCK, W8		
3.8	12	CHC M12-035	SCREW, CHC M12-35		
3.7	12	W12	WASHER LOCK, W12		
3.6	12	FHC M05-030	SCREW FHC M5-30		
3.5	14	H M20	NUT, H20		
3.4	14	W20	WASHER LOCK, W20		
3.3	1	S.1802	VALVE WARNING PLATE	008	
3.2	1	S.1801	SURGE WARNING PLATE	092	ALUMINIUM
3.1	2	See chart I	TIE ROD ( short )	010	C.STEEL
3.0	6	See chart I	TIE ROD ( long )	010	C.STEEL
2.9	8	CT02.89-008	RIVET, Ø2.89-8		
2.8	1	S.0216	NAME PLATE	284	ALUMINIUM
2.7	1	S.0613	KEY, COUPLING 14x9x75	003	C.STEEL
2.6	2	S.0621	GREASER, 1/4 GAS		
2.5	2	S.0200	PLUG, 1/4 GAS		
2.4	1	S.1012	PLUG, 3/8 GAS		
2.3	1	S.0623	FELT JOINT Ø63x46x6		
2.2	2	S.0620	NUT, KM10		
2.1	2	S.0619	WASHER, MB10		
2.0	2	S.0610	GREASE SLINGER	30-20	C.STEEL
1.9	2	S.0611	SPACER, BEARING / HOUSING BEARING	30-18	C.STEEL
1.8	2	S.0617	BEARING, BALL 6410 C3		1,95
1.7	4	S.0862	GRAPHIT RING		GRAPHIT
1.6	2	S.0856	ADAPTER, GRAPHIT RING	50-36	ALUMINIUM 0,1
1.5	2	S.0855	RETAINER, GRAPHIT RING	50-36	ALUMINIUM 0,36
1.4	1	S.4663	CAP, BEARING-OUTLET END	31-46	CAST IRON 1,9
1.3	1	S.4664	CAP, BEARING-INLET END	31-46	CAST IRON 1,67
1.2	2	S.4665	SPACER, BEARING/CAP	31-47	CAST IRON 1,7
1.1	2	S.4661	HOUSING, BEARING	31-45	CAST IRON 10
1.0	1	S.1222	NUT, KM13		
9	1	S.1221	WASHER, MB13		
8	2	S.4611	WAVY SPRING		C.STEEL
7	1	See chart I	SHAFT	51-119	C.STEEL See chart I
6	Variable	S.0668	SHIM, IMPELLER	006	C.STEEL
5	1	See chart I	KEY, IMPELLER	003	C.STEEL
4	See chart I	See chart II	IMPELLER	See chart I	ALUMINIUM 9
3	See chart I	S.4903	SECTION, INTERMEDIATE	51-01	ALUMINIUM 26
2	1	S.0602	HEAD, OUTLET	30-02	CAST IRON 80
1	1	S.0801	HEAD, INLET	50-01	CAST IRON 85

ITEM	QTY.	PART NO.	DESCRIPTION	DWG.	MATERIAL	WEIGHT kg
CONTINENTAL INDUSTRIE S.A						
TYPE 051A OUTLET END DRIVE						
ASSEMBLY: /						
DATE: 04/12/2003						
S <sup>3</sup> TRIVIER/MOIGNANS FRANCE						
SECTIONAL DRAWING						
GRAPHIT RING SEAL						
SCALE: /						
SIZE: A1						
QUOTATION:		DR: BO		CHKD. DR		DWG No. REV.
REVISIONS:						
Ce plan est notre propriété et ne peut être copié ou communiqué à des tiers sans notre autorisation						
51A-RG1A 0						